

## Technical data sheet

### Plastic fiber optics for throughbeam operation

Part no.: 50117750

KF-LY-77TZ-20

#### Contents

- Technical data
- Dimensioned drawings
- Notes
- Further information
- Accessories



For illustration purposes only

## Technical data

### Basic data

|                     |                            |
|---------------------|----------------------------|
| Series              | KF                         |
| Operating principle | Throughbeam principle      |
| Device type         | Transmit and receive fiber |
| Area of application | General applications       |

### Optical data

|                                |                   |
|--------------------------------|-------------------|
| Light beam exit                | Lateral           |
| Fiber core                     | Single fiber core |
| Fiber core material            | Plastic           |
| Active fiber diameter          | 1 mm              |
| Operating range with LV461     | 0 ... 250 mm      |
| Operating range with LV462     | 0 ... 430 mm      |
| Operating range with LV463     | 0 ... 750 mm      |
| Operating range with LV463.XV  | 0 ... 1,125 mm    |
| Operating range with LV463.XR  | 0 ... 1,350 mm    |
| Operating range with LV463I.XR | 0 ... 2,025 mm    |

### Measurement data

|                         |        |
|-------------------------|--------|
| Minimum object diameter | 0.5 mm |
|-------------------------|--------|

### Mechanical data

|                                     |                           |
|-------------------------------------|---------------------------|
| Design                              | Cylindrical               |
| Outer diameter                      | 2.2 mm                    |
| Net weight                          | 31 g                      |
| Head material                       | Stainless steel           |
| Type                                | Plastic fiber optics (KF) |
| Fiber length                        | 2,000 mm                  |
| Fiber sheathing material            | PE                        |
| Fastening of the probe              | M4                        |
| Smallest bending radius (moving)    | R2                        |
| Metric thread on fiber optic sleeve | No                        |
| Laying                              | Flexible                  |
| Damping at $\lambda = 650\text{nm}$ | 210 dB/km                 |

### Environmental data

|                                |               |
|--------------------------------|---------------|
| Ambient temperature, operation | -40 ... 70 °C |
|--------------------------------|---------------|

### Classification

|                       |          |
|-----------------------|----------|
| Customs tariff number | 90011090 |
| ECLASS 5.1.4          | 27270905 |
| ECLASS 8.0            | 27270905 |
| ECLASS 9.0            | 27270905 |
| ECLASS 10.0           | 27270905 |
| ECLASS 11.0           | 27273606 |
| ECLASS 12.0           | 27273606 |
| ECLASS 13.0           | 27273606 |
| ECLASS 14.0           | 27273606 |
| ECLASS 15.0           | 27273606 |
| ECLASS 16.0           | 27273606 |
| ETIM 5.0              | EC002651 |
| ETIM 6.0              | EC002651 |
| ETIM 7.0              | EC002651 |
| ETIM 8.0              | EC002651 |
| ETIM 9.0              | EC002651 |
| ETIM 10.0             | EC002651 |
| UNSPSC 26.08          | 41112103 |

## Dimensioned drawings

All dimensions in millimeters

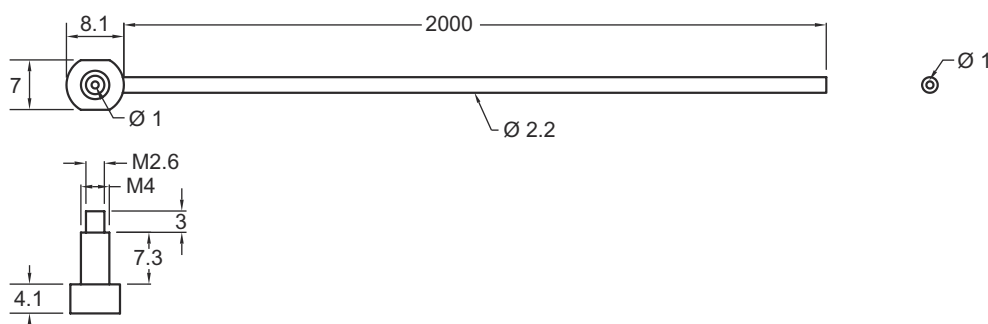

# Notes

|                              |   |
|------------------------------|---|
| <b>Observe intended use!</b> |   |
|                              | <ul style="list-style-type: none"> <li>↪ This product is not a safety sensor and is not intended as personnel protection.</li> <li>↪ The product may only be put into operation by competent persons.</li> <li>↪ Only use the product in accordance with its intended use.</li> </ul> |

## Further information

- Suitable products for operating these fiber optics are the fiber optic amplifiers LV461, LV462B as well as LV463, LV463.XV and LV463.XR.
- The maximum range is limited by the length of the light conductor.
- Operating range measured on a white object (90% diffuse reflection) with the following settings on the fiber optic amplifier:
  - max. response time
  - max. amplification
  - min. switching threshold

## Accessories

### General

|  | Part no.    | Designation  | Article            | Description   |
|--|-------------|--------------|--------------------|---|
|  | 50135984    | KF-PT-SS-619 | Protective housing | Type of article: Protection tube for mechanical protection of plastic fiber optic cables<br>Suitable for: Plastic fiber optics<br>Outer diameter: 4.6 mm<br>Inner diameter: 3 mm<br>Material: Stainless steel |
|  | 50117779    | KL-M02       | Attachment lens    | Functions: Collimated<br>Type of fastening: Screw type  |
|  | 50117784    | KL-M06       | Attachment lens    | Functions: Collimated<br>Type of fastening: Screw type  |
|  | 50117782    | KL-SM02      | Attachment lens    | Functions: 90° - deflection<br>Type of fastening: Screw type  |
|  | 50117785 ** | KLC-4530     | Tool               | Type: Cutting tool  |

\*\* Included in delivery contents

|             |  |
|-------------|--|
| <b>Note</b> |  |
|             | <p>↪ A list with all available accessories can be found on the Leuze website in the Download tab of the article detailed page.</p> |